

IBIZA

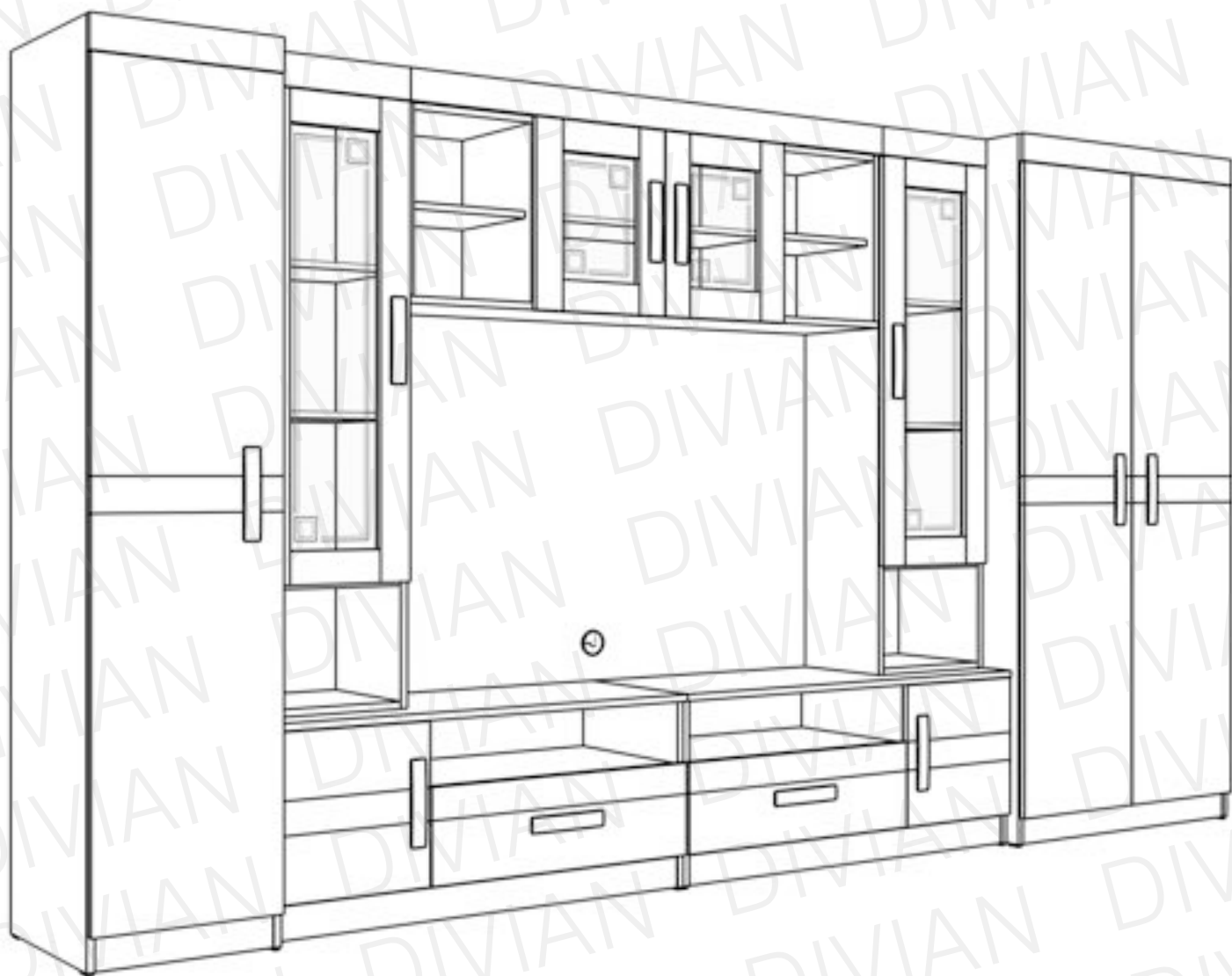

SZERELÉSI ÚTMUTATÓ

Csomag tartalma:

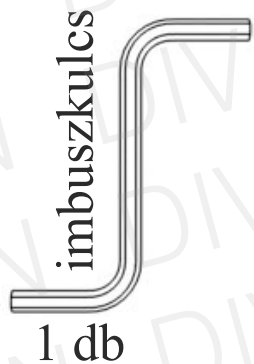

Szekrényelem rögzítő tartalma:

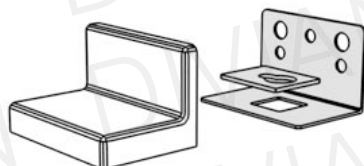

bútor akasztó
2 db



6 db

Szükséges szerszámok:

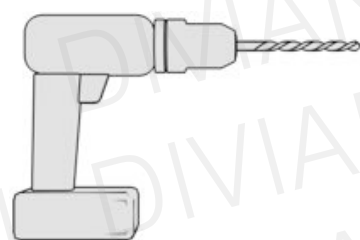

2x2 db

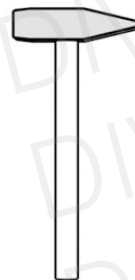

Ne egyedül végezze az összeállítást!

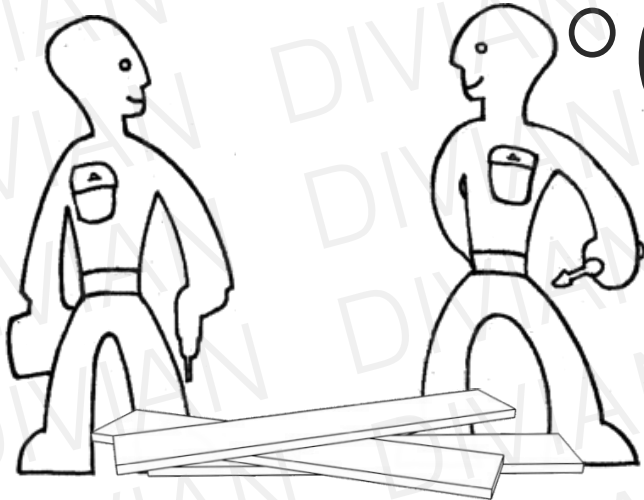

Óvja az elemeket a sérülésektől!

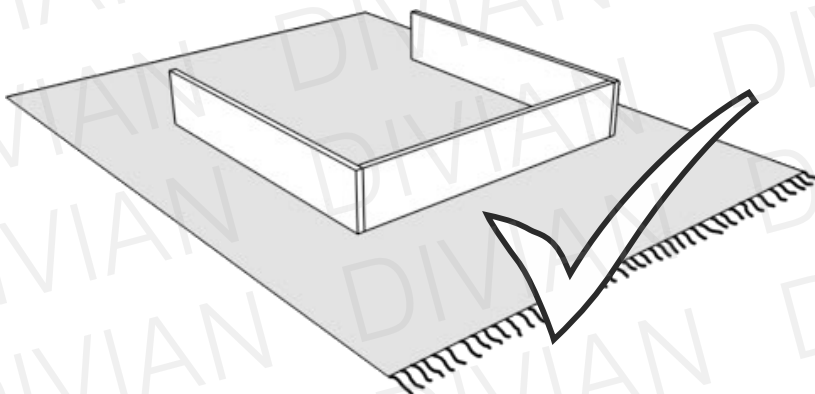
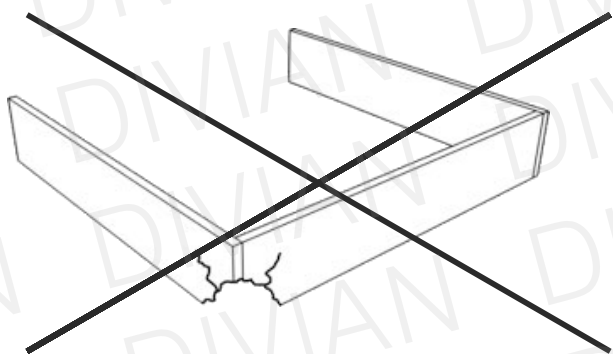

ELEMEK

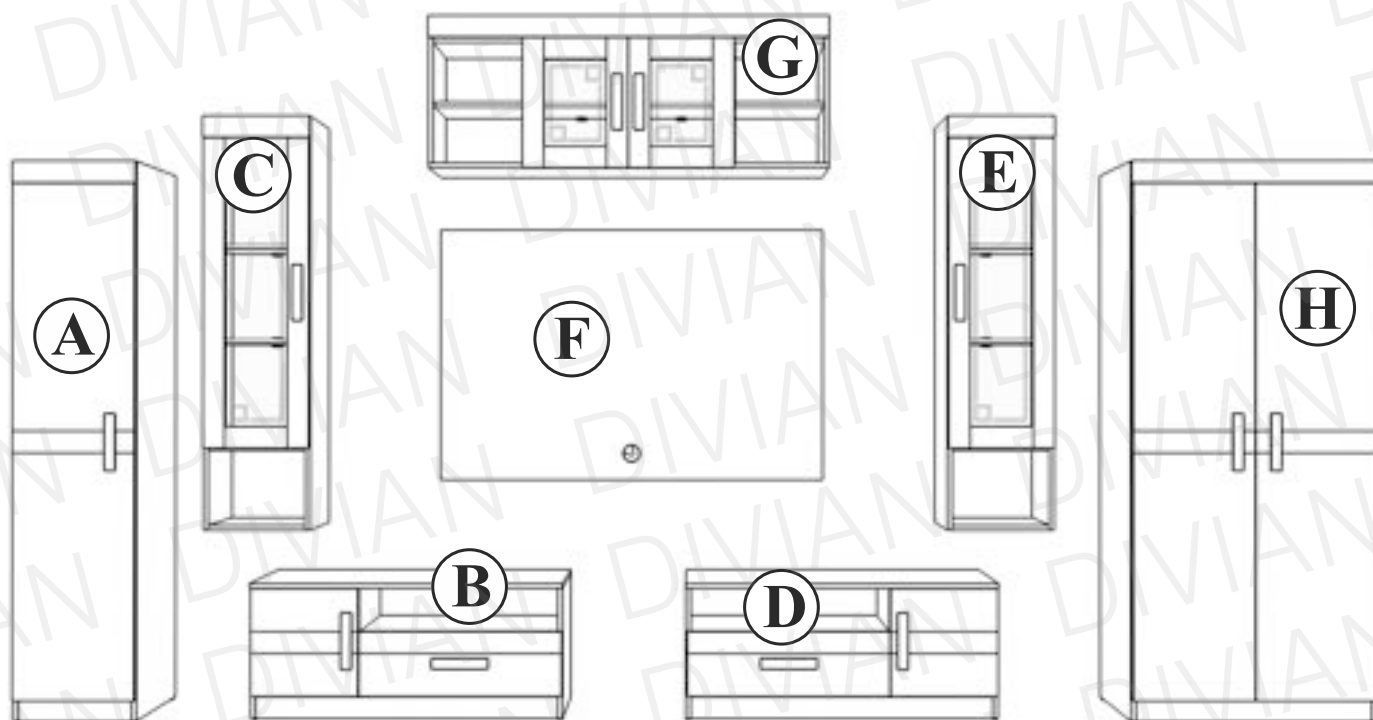

A könnyebb áttekinthetőség érdekében a szerelési útmutatóban az adott elemeket ajtók nélkül ábrázoljuk. Az összeszereléshez Önnek természetesen nem szükséges levennie az ajtókat!

1

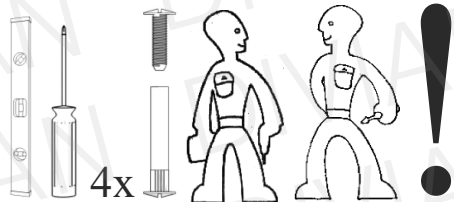

i

Hátfalak síkban legyenek.

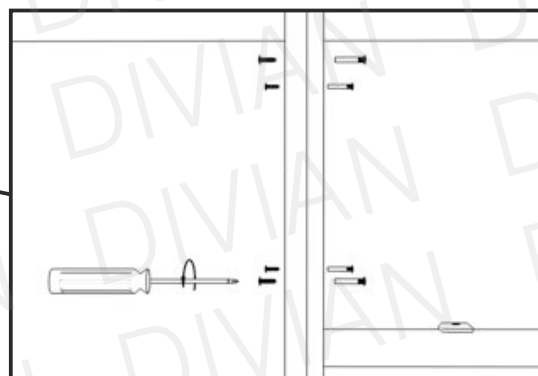
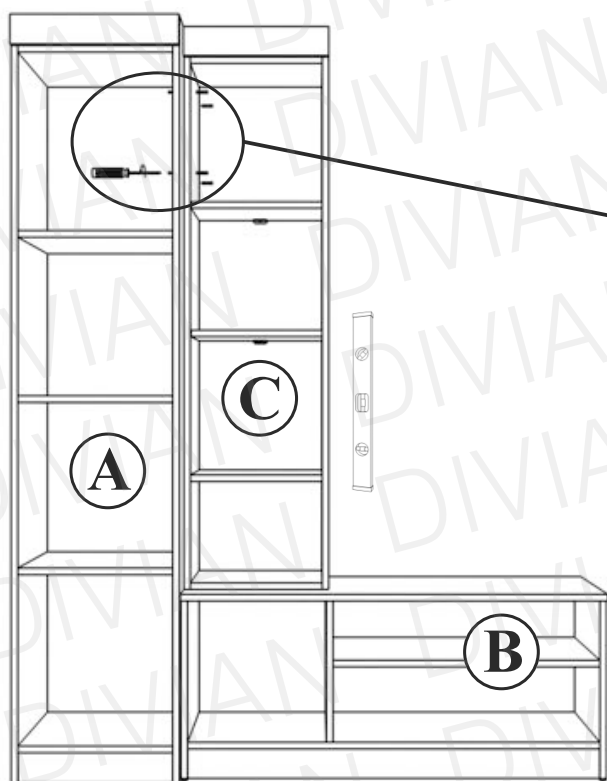

2

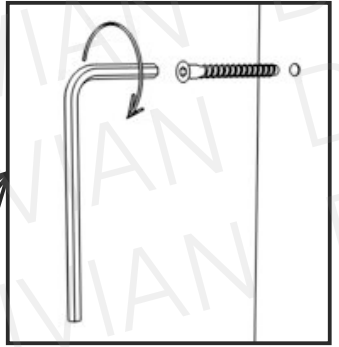
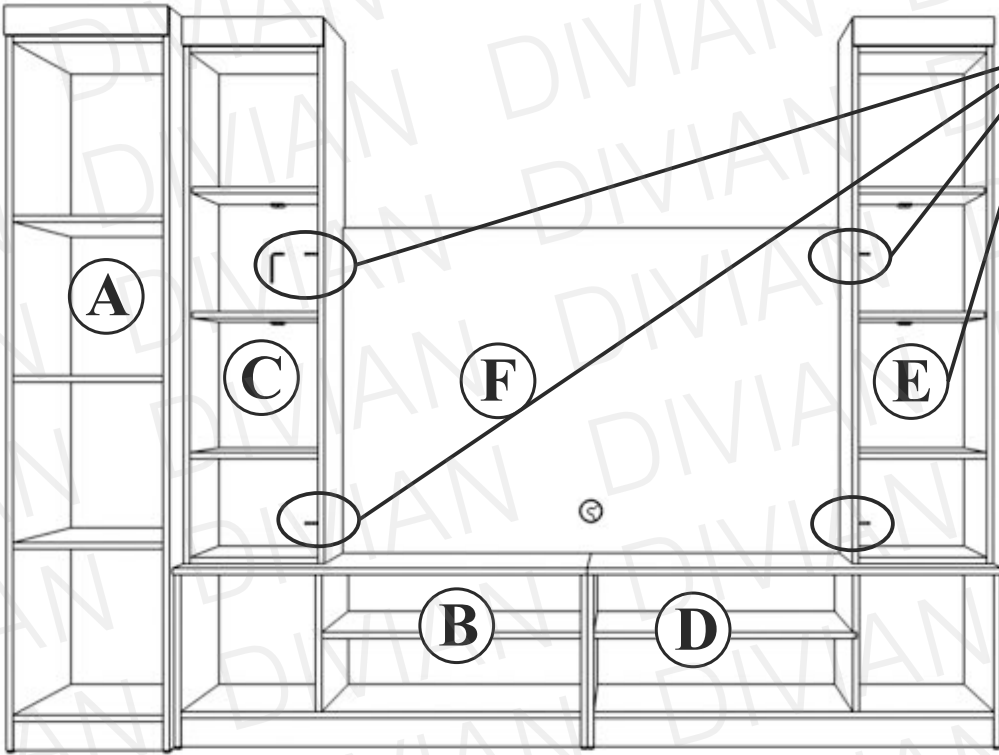

3

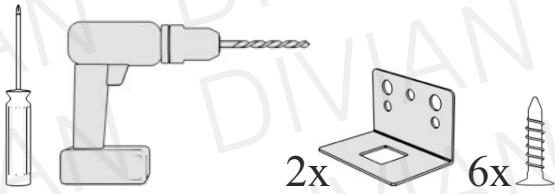

i

Opcionális!

i

G elem hátfalát furja ki!

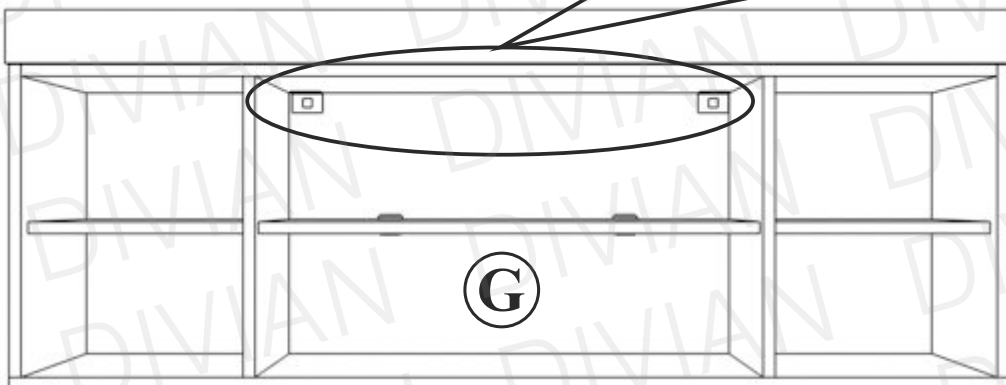
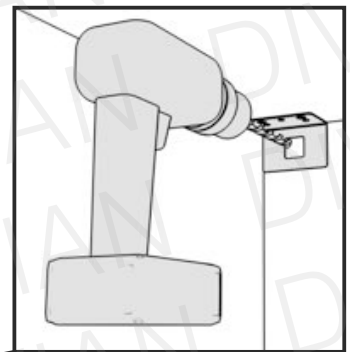
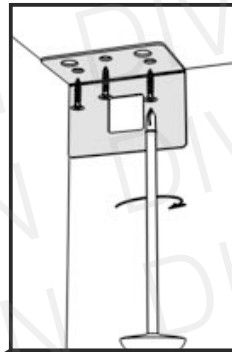

4

8x

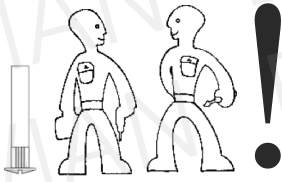

i Opcionális!

i
G elemet emelje a helyére, és a bútor-összehúzó hüvelyének segítségével ideiglenesen rögzítse! Jelölje ki a tipli helyét a szekrénysor mögötti falon!

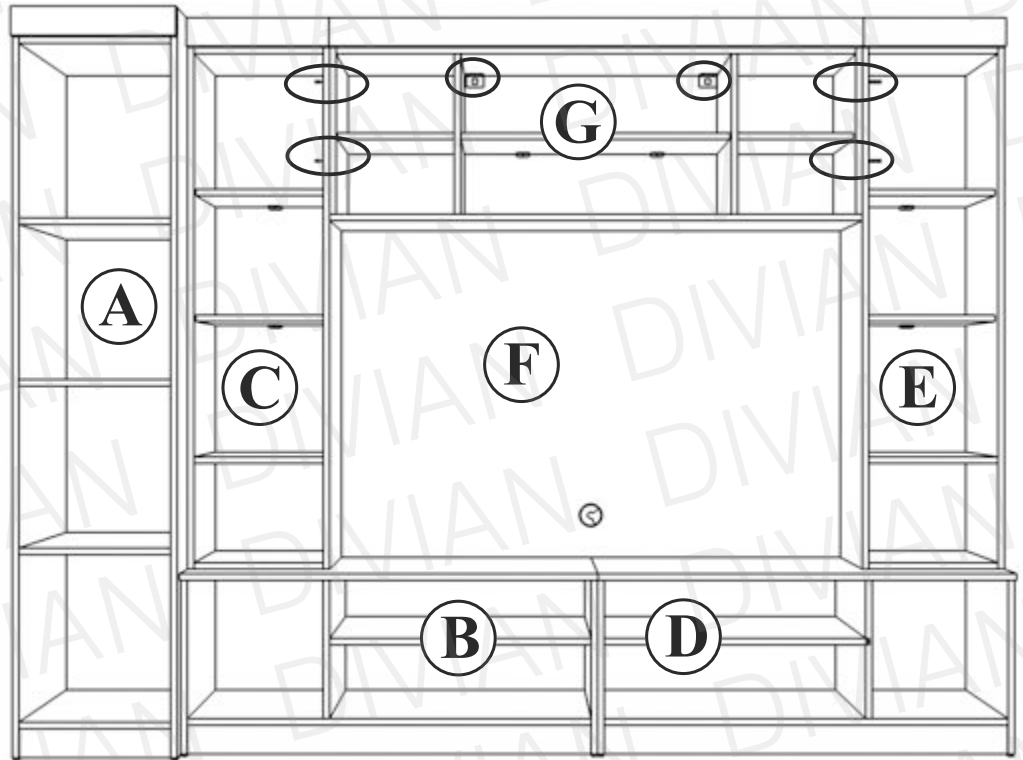

5

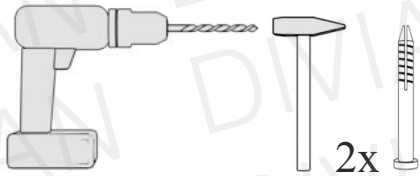

i Opcionális!

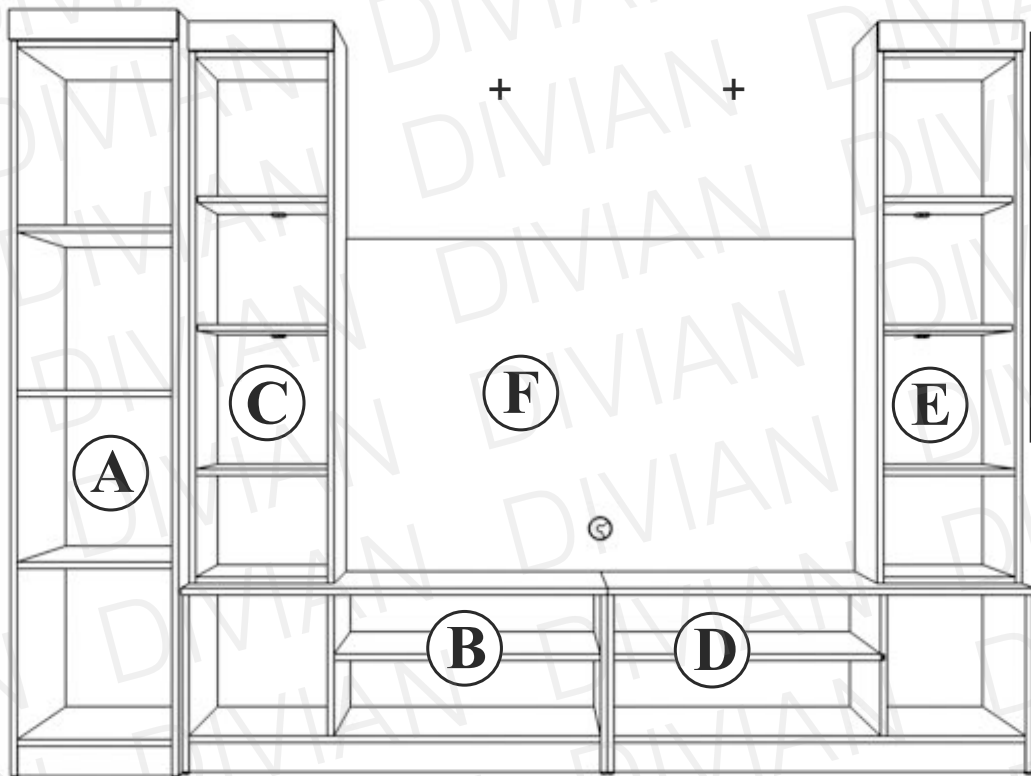

i
G elemet tegye a földre, furja ki a bejelölt pontokat a falon! Üsse be a tipliket!

6

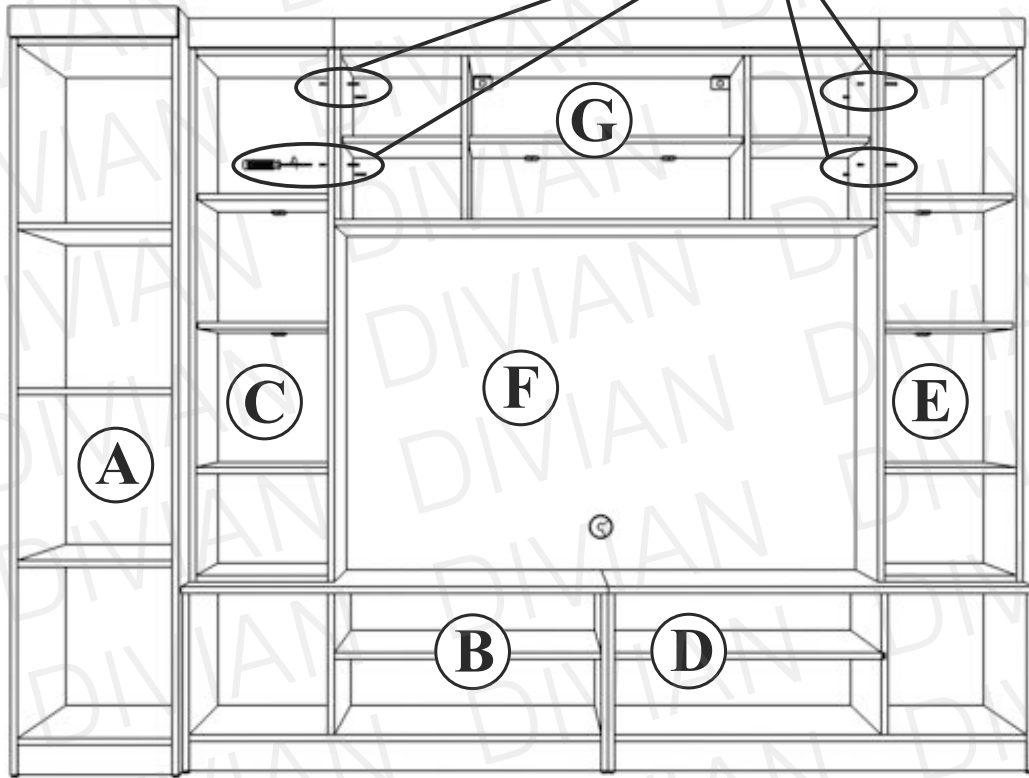
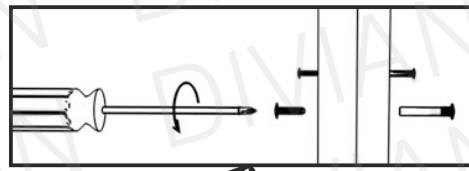
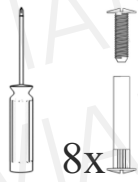

7

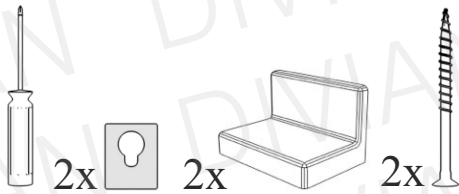

i Opcionális!

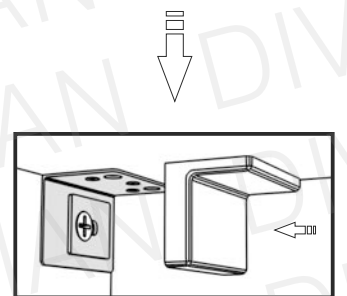
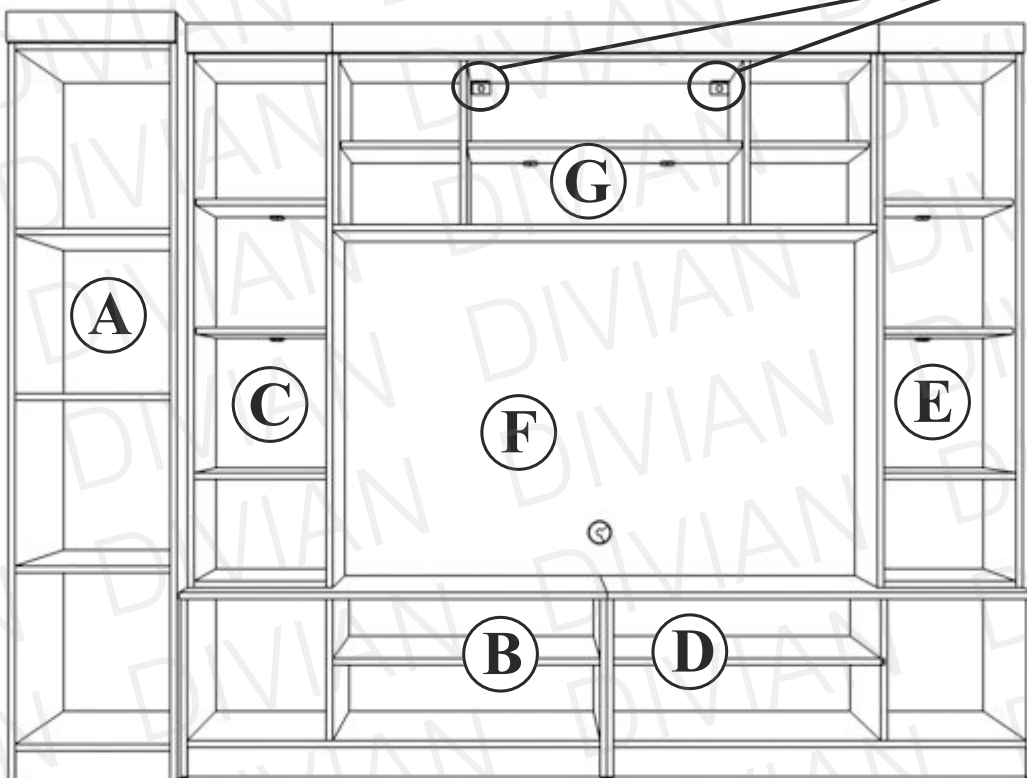
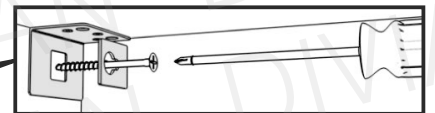

8

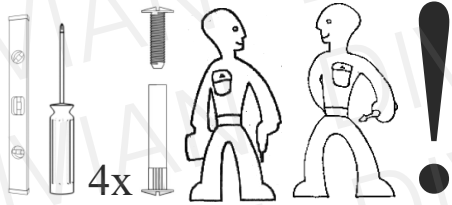

4x

